



# FLAT 14 SWAN COURT, PARADISE STREET

OXFORD, OX1 1JB



# FLAT 14 SWAN COURT PARADISE STREET

OXFORD, OX1 1JB

---

Wonderful Location • Sitting Room • Two Double Bedrooms • Shower Room • Kitchen • Area of Garden • Allocated Parking • No Onward Chain

## DESCRIPTION

A very well presented modern ground floor apartment situated in this central location. A two minutes walk to the modern Westgate Shopping Centre and many Oxford colleges. The light and airy accommodation comprises, entrance hall, open plan sitting/dining room with doors opening onto an area of garden, kitchen, two double bedrooms and a recently refitted shower room with underfloor heating. Other benefits include a Megaflow system. The property benefits from secure allocated parking and no onward chain.

## LOCATION

Swan Court is located in central Oxford and is ideal for those wanting access to the mainline railway and coach stations, the Said Business School, and the various university colleges in central Oxford. The nearby Westgate Shopping Centre offers a wide range of retail shops including John Lewis along with various bars, restaurants, and is just across the road from the Castle Quarter.

## DIRECTIONS

From Oxford City Centre proceed south along Oxpens Road towards the railway station. Proceed over the mini roundabout and take the next right in to St. Thomas Street. Follow the road and after a short distance turn right into Paradise Street. Swan Court will be seen on the right hand side.





## VIEWING ARRANGEMENTS

Strictly by appointment with OX Online Estate Agents. Prior to making an appointment to view, OX Online Estate Agents strongly recommend that you discuss any particular points which are likely to affect your interest in the property with a member of OX Online Estate Agents' staff who has seen the property, in order that you do not make a wasted journey.

## TENURE & POSSESSION

The property is Leasehold with 98 years remaining on the lease. There is an annual service charge of £1,388.11. Offered for sale with no onward chain.

## LOCAL AUTHORITY & COUNCIL TAX

Oxford City Council  
Town Hall  
St Aldates  
Oxford  
OX1 1BX  
Telephone (01865) 249811  
Council Tax Band 'E' amounting to £2518.04 for 2020/21



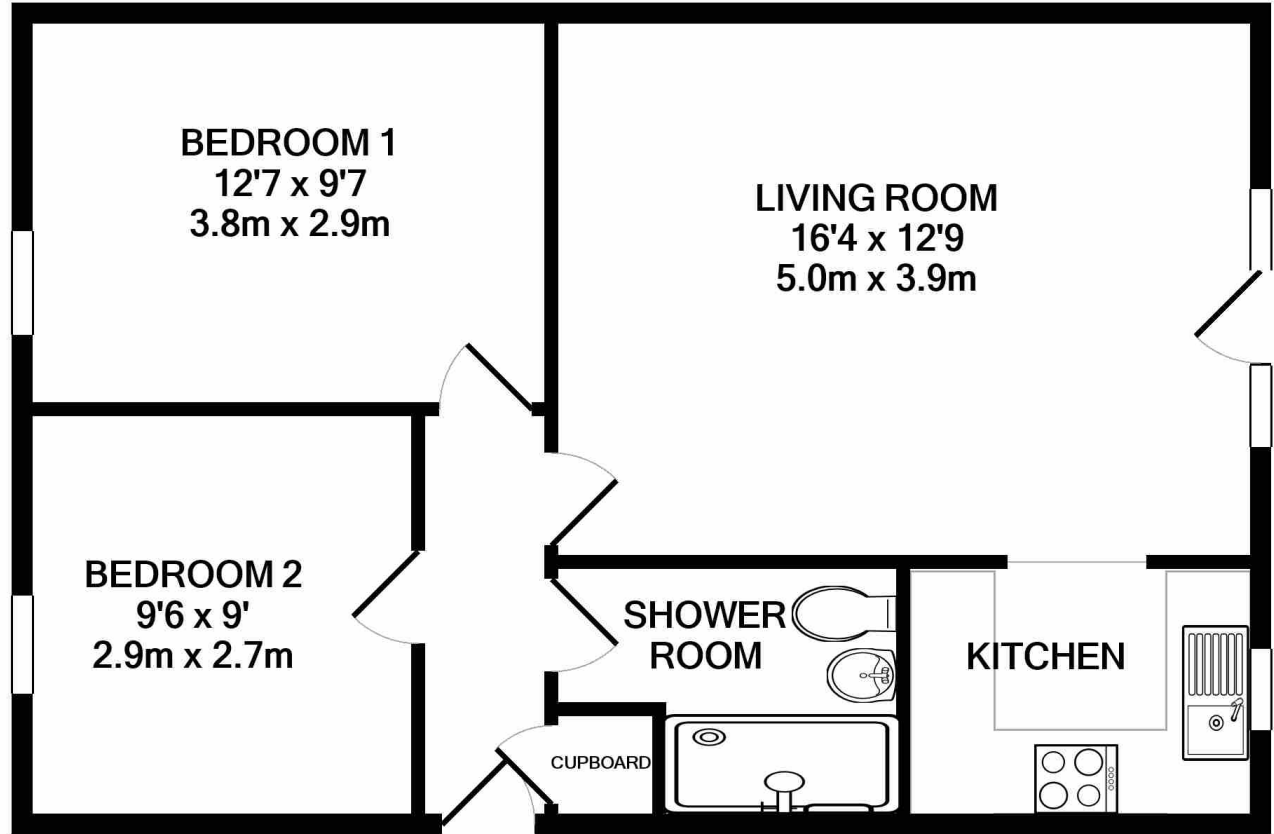

Whilst every attempt has been made to ensure the accuracy of the floor plan contained here, measurements of doors, windows, rooms and any other items are approximate and no responsibility is taken for any error, omission, or mis-statement. This plan is for illustrative purposes only and should be used as such by any prospective purchaser. The services, systems and appliances shown have not been tested and no guarantee as to their operability or efficiency can be given  
Made with Metropix ©2020



**OX**  
ONLINE ESTATE AGENTS

Email: [info@oxsl.uk](mailto:info@oxsl.uk)  
Tel: 01865 507 277  
Website: [www.oxsl.uk](http://www.oxsl.uk)

**IMPORTANT NOTICE** OX Online Estate Agents, their clients and any joint agent gives notice to anyone reading these particulars that: i) the particulars do not constitute part of an offer or contract; ii) all descriptions, dimensions, references to the condition and necessary permissions for use and occupation, and other details are given without responsibility and any intending purchasers should not rely on them as statement or representations of fact. iii) the text, photographs and plans are guidelines only and are not necessarily comprehensive. Any reference to alterations to, or use of, any part of the property does not mean that all necessary planning, building regulations or other consents have been obtained and OX Online Estate Agents have not tested any services, equipment or facilities. A buyer or lessee must satisfy themselves by inspection or otherwise. iv) the descriptions provided therein represent the opinion of the author and whilst given in good faith should not be construed as statements of fact; v) nothing in the particulars shall be deemed a statement that the property is in good condition or otherwise, nor that any services or facilities are in good working order; vi) no person in the employment of Penny & Sinclair has any authority to make or give any representation or warranty whatsoever in relation to this property. vii) all measurements are approximate.